

Caloosa (a rural subdivision)

Lying in sections 27, 28, and 34, Township 41 So., Range 41 East, Palm Beach County, Florida.
April, 1977

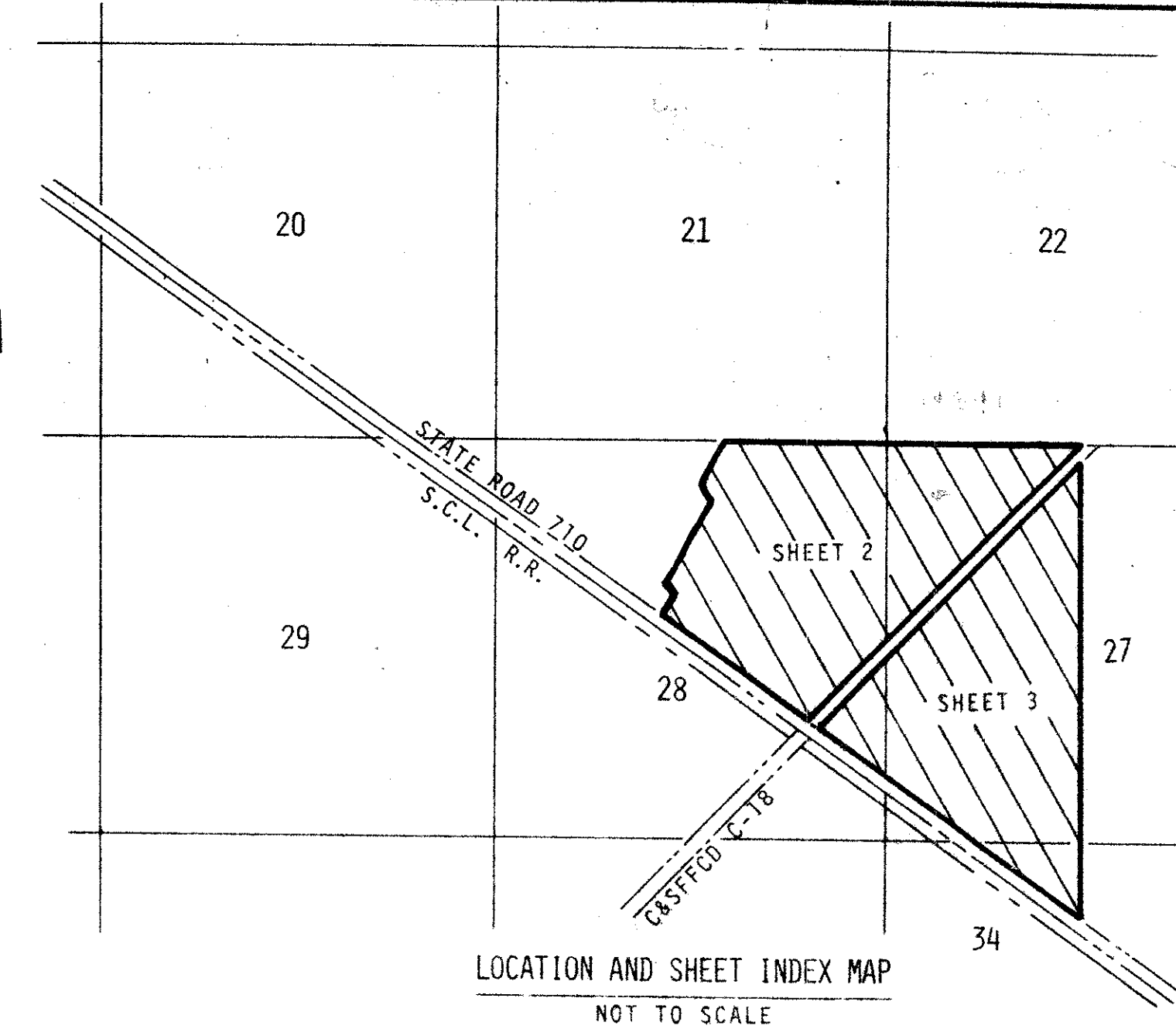

90
STATE OF FLORIDA
COUNTY OF PALM BEACH
This Plat was filed for Record at 10:22 A.M. this 25th day of August AD, 1977 and duly recorded in Plat Book 33 on pages 90, 91 and 92.
JOHN B. DUNKLE, Clerk
Circuit Court
BY: *[Signature]* DC

KNOW ALL MEN BY THESE PRESENTS THAT FOX TRAIL, INC., A FLORIDA CORPORATION, HOLDER OF THE LAND SHOWN HEREON, BEING A PORTION OF SECTIONS 27, 28, AND 34, OF TOWNSHIP 41 SOUTH, RANGE 41 EAST, PALM BEACH COUNTY, FLORIDA, SHOWN HEREON AS CALOOSA, A RURAL SUBDIVISION, AND BEING MORE PARTICULARLY DESCRIBED AS FOLLOWS:

BEGINNING AT A CONCRETE MONUMENT MARKING THE NORTHWEST CORNER OF SAID SECTION 27; THENCE, SOUTH 89°46'07" EAST, ALONG THE NORTH LINE OF SAID SECTION 27, A DISTANCE OF 2395.00 FEET TO THE NORTH ONE-QUARTER CORNER OF SAID SECTION 27; THENCE, SOUTH 06°10'43" WEST, ALONG THE EAST LINE OF THE WEST ONE-HALF OF SAID SECTION 27, A DISTANCE OF 5367.99 FEET TO A 4" x 4" CONCRETE MONUMENT MARKING THE SOUTH ONE-QUARTER CORNER OF SAID SECTION 27; THENCE, SOUTH 01°44'45" WEST, ALONG THE EAST LINE OF THE WEST ONE-HALF OF SAID SECTION 34, A DISTANCE OF 1062.46 FEET TO THE NORTHERLY RIGHT OF WAY LINE OF STATE ROAD NO. 710 (A 200 FOOT ROAD RIGHT OF WAY); THENCE, NORTH 53°17'12" WEST, ALONG SAID NORTHERLY RIGHT OF WAY LINE A DISTANCE OF 1673.71 FEET TO THE NORTH LINE OF SAID SECTION 34; THENCE, CONTINUE NORTH 53°17'12" WEST, ALONG THE NORTHERLY RIGHT OF WAY LINE OF SAID STATE ROAD 710, A DISTANCE OF 1122.85 FEET TO THE WEST LINE OF SAID SECTION 27; THENCE, CONTINUE NORTH 53°17'12" WEST, ALONG THE NORTHERLY RIGHT OF WAY LINE OF STATE ROAD NO. 710, A DISTANCE OF 1349.54 FEET TO THE SOUTHEASTERLY RIGHT OF WAY LINE OF CENTRAL AND SOUTHERN FLORIDA FLOOD CONTROL DISTRICT CANAL C-18 (A 220 FOOT CANAL RIGHT OF WAY); THENCE, CONTINUE NORTH 53°17'12" WEST, ALONG THE NORTHERLY RIGHT OF WAY LINE OF STATE ROAD NO. 710, A DISTANCE OF 223.86 FEET TO THE NORTHWESTERLY RIGHT OF WAY LINE OF SAID CENTRAL AND SOUTHERN FLORIDA FLOOD CONTROL DISTRICT CANAL C-18; THENCE, CONTINUE NORTH 53°17'12" WEST, ALONG THE NORTHERLY RIGHT OF WAY LINE OF SAID STATE ROAD NO. 710, A DISTANCE OF 2192.00 FEET; THENCE, NORTH 36°42'48" EAST, A DISTANCE OF 630.00 FEET; THENCE, NORTH 53°17'12" WEST, A DISTANCE OF 164.84 FEET; THENCE, NORTH 45°10'57" EAST, A DISTANCE OF 638.27 FEET TO A POINT ON A CURVE CONCAVE TO THE NORTHEAST HAVING A RADIUS OF 400.00 FEET AND WHOSE RADIUS POINT BEARS SOUTH 05°27'21" WEST; THENCE, NORTHERLY ALONG THE ARC OF SAID CURVE THROUGH A CENTRAL ANGLE OF 31°55'27", A DISTANCE OF 222.87 FEET TO THE POINT OF TANGENCY; THENCE, NORTH 27°22'48" EAST, A DISTANCE OF 1049.94 FEET TO THE POINT OF CURVATURE OF A CURVE TO THE LEFT, HAVING A RADIUS OF 510.91 FEET; THENCE, NORTHERLY ALONG THE ARC OF SAID CURVE THROUGH A CENTRAL ANGLE OF 28°25'22" A DISTANCE OF 253.45 FEET TO THE END OF SAID CURVE AND THE NORTH LINE OF SAID SECTION 28; THENCE, NORTH 88°57'26" EAST, ALONG THE NORTH LINE OF SAID SECTION 28, A DISTANCE OF 2195.00 FEET TO THE NORTHEAST CORNER OF SAID SECTION 28 AND THE POINT OF BEGINNING (P.O.B.):

LESS HOWEVER, ALL THAT PART OF SAID CENTRAL AND SOUTHERN FLORIDA FLOOD CONTROL DISTRICT CANAL C-18, LYING WITHIN THE ABOVE DESCRIBED PARCEL OF LAND.
SUBJECT TO EXISTING EASEMENTS OF RECORD.
CONTAINING: 507.60 ACRES, MORE OR LESS.

FOX TRAIL, INC., A FLORIDA CORPORATION, HAS CAUSED THE SAME TO BE SURVEYED AND PLATTED AS SHOWN HEREON AND DOES HEREBY DEDICATE UNTO NORTHERN PALM BEACH COUNTY WATER CONTROL DISTRICT A PERPETUAL EASEMENT IN AND TO ALL DRAINAGE EASEMENTS SHOWN HEREON TOGETHER WITH THE EXCLUSIVE RIGHT TO TAKE, USE, SELL, DISPOSE OF AND ENJOY ANY TIMBER, EARTH, SPOIL, STONE, ROCK OR GRAVEL LYING IN OR UPON SAID DRAINAGE EASEMENTS AND DOES HEREBY DEDICATE UNTO NORTHERN PALM BEACH COUNTY WATER CONTROL DISTRICT A PERPETUAL NON-EXCLUSIVE EASEMENT IN AND TO ALL INGRESS AND EGRESS EASEMENTS AS SHOWN HEREON FOR THE PURPOSE OF MAINTENANCE.

FOX TRAIL, INC.
ATTEST: *[Signature]* SECRETARY, WILMA A. ELMORE
BY: *[Signature]* PRESIDENT, GEORGE T. ELMORE

NORTHERN PALM BEACH COUNTY WATER CONTROL DISTRICT HEREBY ACCEPTS THE GRANT HEREIN CONTAINED OF DRAINAGE EASEMENTS AND AGREES TO MAINTAIN SAME AS PART OF WATER CONTROL SYSTEM AND HEREBY ACCEPTS THE GRANT HEREIN CONTAINED OF INGRESS AND EGRESS EASEMENTS AND AGREES TO MAINTAIN SAME.
NORTHERN PALM BEACH COUNTY WATER CONTROL DISTRICT
BY: *[Signature]* CHAIRMAN

ACKNOWLEDGEMENT:
STATE OF FLORIDA }
COUNTY OF PALM BEACH } FOX TRAIL, INC.
BEFORE ME PERSONALLY APPEARED GEORGE T. ELMORE AND WILMA A. ELMORE, TO ME WELL KNOWN, AND KNOWN TO ME TO BE THE INDIVIDUALS DESCRIBED IN AND WHO EXECUTED THE FOREGOING INSTRUMENT AS GEORGE T. ELMORE, PRESIDENT AND WILMA A. ELMORE, SECRETARY OF THE ABOVE NAMED, FOX TRAIL, INC., A FLORIDA CORPORATION, AND SEVERALLY ACKNOWLEDGED TO AND BEFORE ME THAT THEY EXECUTED SUCH INSTRUMENT AS SUCH PRESIDENT AND SECRETARY, RESPECTIVELY, OF SAID CORPORATION, AND THAT THE SEAL AFFIXED TO THE FOREGOING INSTRUMENT IS THE CORPORATE SEAL OF SAID CORPORATION AND THAT IT WAS AFFIXED TO SAID INSTRUMENT BY DUE AND REGULAR CORPORATE AUTHORITY, AND THAT SAID INSTRUMENT IS THE FREE ACT AND DEED OF SAID CORPORATION.
WITNESS MY HAND AND OFFICIAL SEAL THIS, 25th DAY OF JULY, A.D., 1977.
[Signature]
NOTARY PUBLIC
MY COMMISSION EXPIRES OCTOBER 18, 1977

MORTGAGEE'S CONSENT:
STATE OF FLORIDA
COUNTY OF PALM BEACH
THOMAS M. METTLER, AS TRUSTEE, HEREBY CERTIFIES THAT HE IS THE HOLDER OF A MORTGAGE UPON THE PROPERTY DESCRIBED HEREON AND DOES HEREBY JOIN IN AND CONSENT TO THE DEDICATION OF THE LAND DESCRIBED IN SAID DEDICATION BY THE OWNER THEREOF AND AGREES THAT THE MORTGAGE, WHICH IS RECORDED IN OFFICIAL RECORD BOOK 2686 ON PAGE(S) 92 OF THE PUBLIC RECORDS OF PALM BEACH COUNTY, FLORIDA, SHALL BE SUBORDINATED TO THE DEDICATION SHOWN HEREON.
IN WITNESS WHEREOF, I, THOMAS M. METTLER, AS TRUSTEE, DO HEREBY SET MY HAND AND SEAL THIS 21st DAY OF AUGUST, 1977.
[Signature] THOMAS M. METTLER, AS TRUSTEE
WITNESS: *[Signature]*
WITNESS: *[Signature]*

ACKNOWLEDGMENT:
STATE OF FLORIDA
COUNTY OF PALM BEACH
BEFORE ME PERSONALLY APPEARED THOMAS M. METTLER, AS TRUSTEE, TO ME WELL KNOWN AND KNOWN TO ME TO BE THE PERSON DESCRIBED IN AND WHO EXECUTED THE FOREGOING INSTRUMENT, AND ACKNOWLEDGED BEFORE ME THAT HE EXECUTED SAID INSTRUMENT FOR THE PURPOSES EXPRESSED THEREIN.
WITNESS MY HAND AND OFFICIAL SEAL THIS 21st DAY OF AUGUST, 1977.
NOTARY PUBLIC: *[Signature]*
MY COMMISSION EXPIRES OCTOBER 18, 1977

TITLE CERTIFICATION:
STATE OF FLORIDA
COUNTY OF PALM BEACH
I, ROBERT C. SCOTT, A DULY LICENSED ATTORNEY, IN THE STATE OF FLORIDA, DO HEREBY CERTIFY THAT I HAVE EXAMINED THE TITLE TO THE HEREON DESCRIBED PROPERTY; THAT I FIND THE TITLE TO THE PROPERTY IS VESTED TO FOX TRAIL, INC., A FLORIDA CORPORATION; THAT THE CURRENT TAXES HAVE BEEN PAID; AND THAT I FIND THE PROPERTY IS ENCUMBERED BY THE MORTGAGES SHOWN HEREON AND THAT ALL MORTGAGES ARE SHOWN AND ARE TRUE AND CORRECT.
BY: *[Signature]*
ROBERT C. SCOTT, ATTORNEY

SURVEYORS' CERTIFICATE
THIS IS TO CERTIFY THAT THE PLAT SHOWN HEREON IS A TRUE AND CORRECT REPRESENTATION OF A SURVEY MADE UNDER MY RESPONSIBLE DIRECTION AND SUPERVISION AND THAT SAID SURVEY IS ACCURATE TO THE BEST OF MY KNOWLEDGE AND BELIEF AND THAT (P.R.M.'S) PERMANENT REFERENCE MONUMENTS HAVE BEEN PLACED AS REQUIRED BY LAW AND FURTHER THAT THE SURVEY DATA COMPLIES WITH ALL REQUIREMENTS OF CHAPTER 177 FLORIDA STATUTES, AS AMENDED, AND ORDINANCES OF PALM BEACH COUNTY, FLORIDA.
[Signature]
WILLIAM R. VAN COPEN
REGISTERED SURVEYOR NO. 2424
STATE OF FLORIDA
APPROVAL - PALM BEACH COUNTY, FLORIDA
BOARD OF COUNTY COMMISSIONERS
THIS PLAT IS HEREBY APPROVED FOR RECORD, THIS 23rd DAY OF August, A.D., 1977.
BY: *[Signature]* (SEAL)
CHAIRMAN LAKE LYNN
COUNTY ENGINEER
THIS PLAT IS HEREBY APPROVED FOR RECORD, THIS 23rd DAY OF August, A.D., 1977.
BY: *[Signature]* (SEAL)
HERBERT F. KAHLERT
ATTEST: JOHN B. DUNKLE, CLERK
BOARD OF COUNTY COMMISSIONERS
BY: *[Signature]* DEPUTY CLERK

SPECIAL NOTES:
1. INDICATES A PERMANENT REFERENCE MONUMENT (P.R.M.) FLORIDA CERTIFICATE NO. 2424.
2. ALL LOTS SHOWN HEREON CONTAIN MORE THAN 217,800 SQUARE FEET OR 5.00/ACRES.
3. THE BEARINGS AS SHOWN HEREON ARE BASED ON THE BEARING OF NORTH EAST AS SHOWN ALONG THE RIGHT OF WAY LINES OF STATE ROAD NO. 710 AS PER PLATS ON FILE IN ROAD DISTRICT 2, PAGES 149 THROUGH 154, INCLUSIVE, PUBLIC RECORDS, PALM BEACH COUNTY, FLORIDA.

0219-000
57
[Signature]

27, 28, + 34 / 41/41

THIS INSTRUMENT WAS PREPARED BY ROBERT J. WHIDDEN OF BENCH MARK LAND SURVEYING AND MAPPING, INC., 2300 PALM BEACH LAKES BOULEVARD, SUITE 109, WEST PALM BEACH, FLORIDA. PHONE 689-2111.

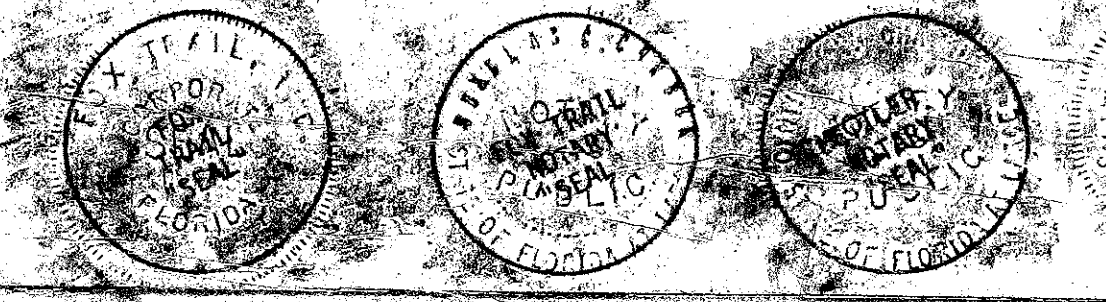

CALOOSA



BENCH MARK
LAND SURVEYING AND MAPPING, INC.
CONRAD W. SCHAEFER CONSULTING ENGINEERS, INC.
PALM BEACH COUNTY, FLORIDA
RECORD PART
DESIGNED: W.S.K. CHECKED: [] JOB NO: 7-042
DATE: APR. 1977 SCALE: 1" = 20' APPROVED: []
3